



## Our Vision

*‘To consistently  
design and install  
quality water  
cooling solutions’*

## Contact Us

**Vistech Cooling Systems Ltd**

Unit IA, Church Lane Estate  
Church Lane, Plummers Plain  
Horsham, UK

[info@vistechcooling.co.uk](mailto:info@vistechcooling.co.uk)

[vistechcooling.co.uk](http://vistechcooling.co.uk)

+44 (0)1403 892 622



DESIGN | INSTALL | MAINTAIN

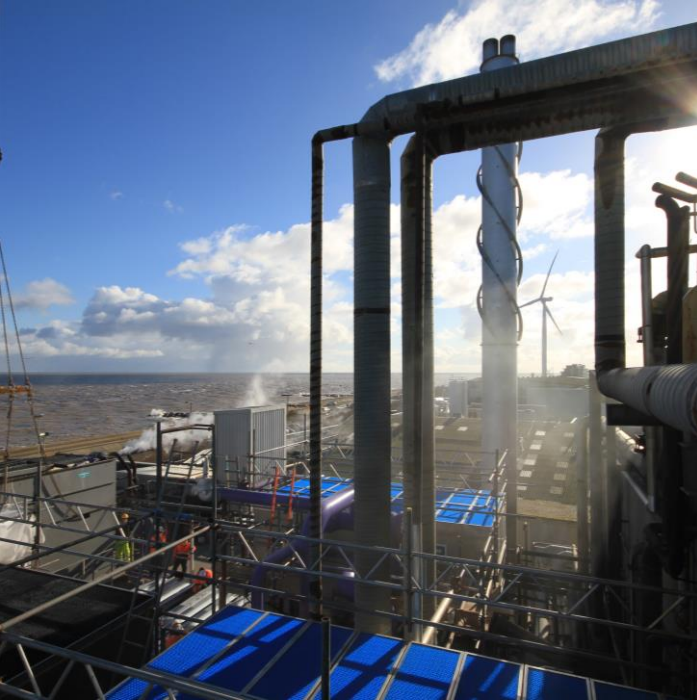

## Who we are

Vistech is an established engineering business focused on delivering high quality industrial and commercial cooling solutions that offer environmental, sustainable and financial returns for our clients.

We provide consultancy, technical design, project management, installation, CDM and maintenance services for industrial and commercial cooling system projects.

We help our clients identify inefficiencies in their cooling processes, and design and deliver solutions that are in line with their business objectives over the long term.



## Our Services

- Cooling System Design Services
- Performance Monitoring Solutions
- Cooling Equipment Supply
- Turnkey Project Installations
- CDM Principal Contractor Services
- Cooling Tower Refurbishment
- Project Management
- Cooling System Maintenance



All senior technical personnel have in excess of 20 years' experience within the evaporative cooling technology market.

# Cooling System Design Services

Centred on our expertise in water cooling system design we are able to design complete water cooling systems for both our industrial and commercial clients.

Using 3D scanning and modelling capabilities we are able to bring our clients projects to life and identify any risks prior to works commencing.

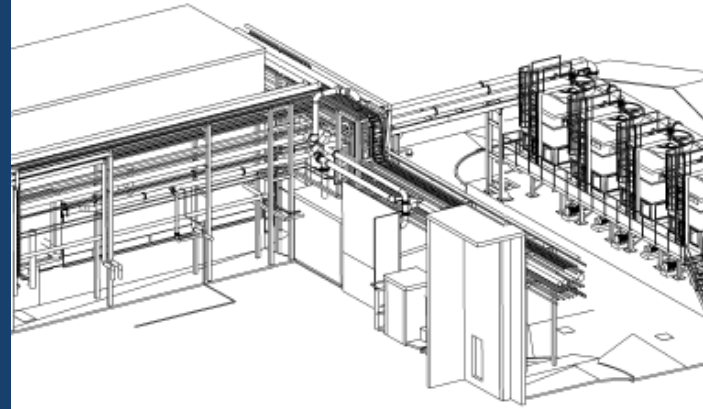

# Services

- Thermodynamic Analysis
- Fluid Dynamic Analysis
- Structural Design
- 3D Site Scanning
- General Arrangements
- Piping & Instrumentation Diagrams
- 3D Models
- Site Utilities Surveys

Working with our clients, from initial concept and front end engineering, through to detailed design; we create solutions that make water and energy savings a measurable reality.

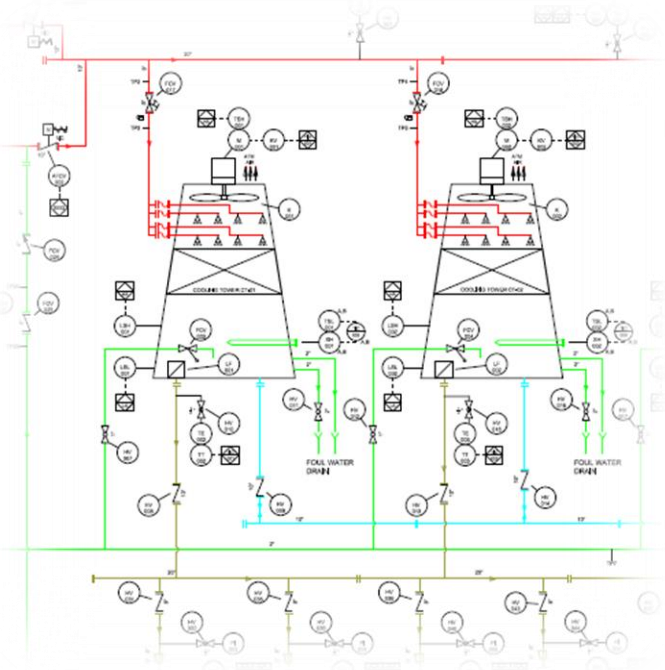

# Performance Monitoring Solutions

Understanding energy and water consumption in industrial processes is central to the optimal selection of new plant and machinery. With water and electricity costs continually rising in line with environmental demands to reduce consumption, it is imperative that only the resources needed are used in the manufacturing and processing of products

Don't fall into the trap of basing your cooling system design on historic data, in the same way you wouldn't base current production levels on 20-year-old production data.

Old design duties may have been good at the time of the original installation, but much can change throughout the lifecycle of a cooling system. Furthermore, extra capacity built in at inception may never have been utilised through a change in business or market conditions.

Throughout the cooling system lifecycle, the process itself may have become more efficient or the equipment being cooled requires less cooling, leaving excess capacity which equates to excess consumption of water and power.



## Contact Us

### **Vistech Cooling Systems Ltd**

Unit 1A, Church Lane Estate

Church Lane, Plummers Plain

Horsham, UK

[info@vistechcooling.co.uk](mailto:info@vistechcooling.co.uk)

[vistechcooling.co.uk](http://vistechcooling.co.uk)

+44 (0)1403 892 622



DESIGN | INSTALL | MAINTAIN

# Performance Monitoring Process

The Vistech Performance Monitoring Solution starts with installing non-intrusive sensors onto the live cooling loop. There is no down-time required from the client to complete the onsite installation. The sensors are then connected to the remote monitoring server through a secure 4G gateway - separate from any onsite networks.

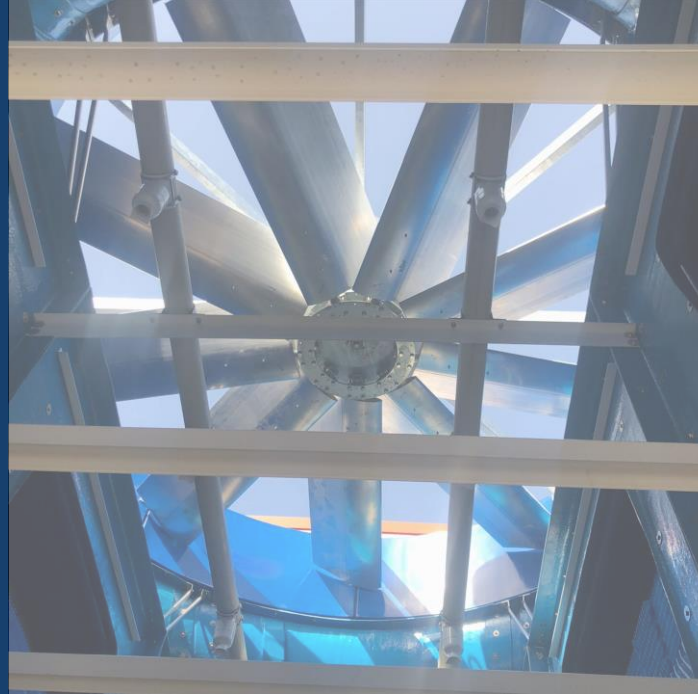

# Data Collection

Data is collected for an agreed time period – typically during a two-week production cycle when production levels are at their highest.

The data is then processed off site at Vistech's office enabling the selection of optimised cooling equipment - guaranteeing the specified cold-water temperature for your cooling process.

Following the specification of the cooling equipment, Vistech will return to site to collect our equipment and to provide consultative technical advice to enable you to make an informed decision on your future cooling system based on real-time data analysis with a supporting report.

## Performance Monitoring Solutions

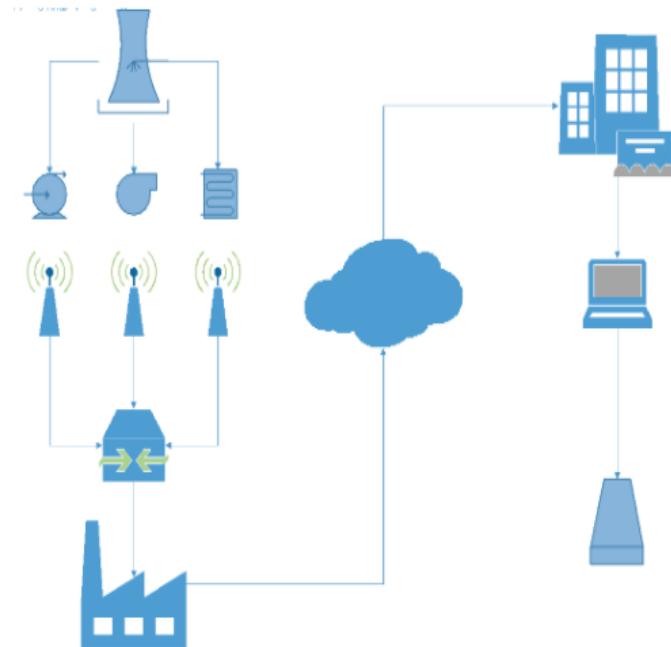

# Turnkey Solutions

At Vistech we are dedicated to designing cooling solutions that provide you, our client, with the most efficient means of cooling aligned to your specific business objectives. Whether you are looking at energy savings, environmental impact or a change in cooling capacity Vistech can deliver a solution that meets your needs.



## Contact Us

### **Vistech Cooling Systems Ltd**

Unit 1A, Church Lane Estate

Church Lane, Plummers Plain

Horsham, UK

[info@vistechcooling.co.uk](mailto:info@vistechcooling.co.uk)

[vistechcooling.co.uk](http://vistechcooling.co.uk)

+44 (0)1403 892 622



DESIGN | INSTALL | MAINTAIN

# Turnkey Solutions

Vistech will work alongside your team during all stages of your project; from the initial gathering of requirements through the design phase into installation and will continue to provide you with ongoing service through our maintenance agreements.



# Project Management

All our projects are managed by our in-house team of experienced project engineers to ensure that your requirements are delivered on time and to budget. We will keep you informed of progress every step of the way and liaise with other subcontractors as instructed by you.

Our **installation** engineering team have on average 15 years' experience within the cooling industry. This level of experience means that we can adjust and adapt quickly to changing requirements as your project progresses





## Cooling Equipment Supply

Vistech are able to supply a wide range of cooling equipment for both industrial and commercial projects.

Through collaboration with our Spanish partner [EWK](#) we are able to bring the latest evaporative cooling technology to our clients using 'Smart' Cooling Towers and Condensers as well as Adiabatic Coolers.

In addition we supply air cooled chillers, filtration systems and cooling system pumps as well as a range of spares for existing systems.

## Contact Us

### **Vistech Cooling Systems Ltd**

Unit IA, Church Lane Estate  
Church Lane, Plummers Plain  
Horsham, UK

[info@vistechcooling.co.uk](mailto:info@vistechcooling.co.uk)

[vistechcooling.co.uk](http://vistechcooling.co.uk)

+44 (0)1403 892 622



DESIGN | INSTALL | MAINTAIN



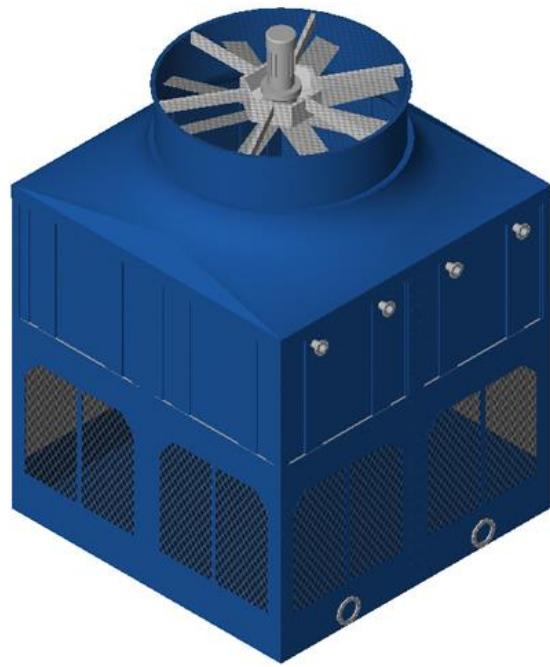

## Cooling Towers

We can offer both forced draught and induced draught towers both as closed circuit and open circuit options with either axial or centrifugal fan sets.

We are also able to offer evaporative condensers within our closed-circuit range, a common solution within the food processing industry.



## EWK - Moducell

- Suitable for large flows up to 10,000m<sup>3</sup>/hr
- Modular design in GRP
- Corrosion Free
- Standard Fill materials in Polypropylene with anti-legionella treatment
- Materials highly resistant to all aggressive conditions, as well as to extreme temperatures
- Pre-assembled at the factory



## EWK – Open Circuit Tower

- Compact Polyester Casing
- Corrosion Free
- Low Energy Consumption
- Easy Maintenance
- Broad Range (From 4 to 500 m<sup>3</sup>/h)
- Modular Design
- Pre-assembled at the factory

# EWK-I – Closed Circuit

- FRP Casing and stainless-steel plate heat exchanger
- Direct driven fan motor (no pulleys and belts)
- Total corrosion resistance
- Easy cleaning
- Easy installation



# EWK-C – Closed Circuit

- Low sound levels
- Low height
- No Vibration transmission
- FRP Casing, reduced maintenance and total corrosion protection
- Plastic internals

# EWK-DC – Closed Circuit

- Low sound level
- Low height
- No vibration transmission
- FRP Casing, for low maintenance and total corrosion resistance
- Plastic internals for complete corrosion resistance
- Modular design
- Easy installation





# Adiabatic Coolers

Our evaporative panel adiabatic coolers typically use less than 10% of the water consumption of a traditional cooling tower and remove the risk of harmful legionella bacteria.

By using intelligent control and highly efficient EC fans, adiabatic cooling could be the smart choice when looking to replace your cooling tower.

- Highly efficient heat exchange
- Low noise
- Ease of installation and use
- Suitable for outdoor applications

# Contact Us

## Vistech Cooling Systems Ltd

Unit 1A, Church Lane Estate  
Church Lane, Plummers Plain  
Horsham, UK

[info@vistechcooling.co.uk](mailto:info@vistechcooling.co.uk)

[vistechcooling.co.uk](http://vistechcooling.co.uk)

+44 (0)1403 892 622



DESIGN | INSTALL | MAINTAIN

<https://www.vistechcooling.co.uk/products/adiabatic-coolers-dry-air-coolers/>

# Cooling Equipment Fabrication

Vistech are able to design and manufacture bespoke cooling equipment. Where limitations in physical space don't allow for standard 'off the shelf' solutions or our clients required something very specific, we can retrofit cooling equipment to match or exceed the performance and quality of retired plant.



# Equipment

- Stainless Steel Water Tanks
- Cooling Towers
  - Induced Draft
  - Forced Draft
  - Crossflow
- Fan casings
- Fan assemblies



Bespoke  
Fabrication  
Designed and  
Engineered to  
approved quality  
standards



# Cooling Tower Refurbishment

Our onsite team of experienced technical engineers provide refurbishment services across all makes and models of cooling towers and evaporative condensers nationwide.

Refurbishing your cooling tower not only extends its useful working life but can also improve the thermal performance beyond that of its original design specification.

Vistech offer refurbishment services and solutions designed to improve performance, reduce operational running costs and increase the safety of your cooling towers.



Ensuring cooling towers are kept free of legionella takes more than just water treatment. Corrosion, damaged or inefficient drift eliminators and scaled packing are ideal conditions for bacterial growth and aerosol release

# Services

- Replacement of packing, drift eliminators and sound attenuators with world-class high-efficiency designs
- High performance GRP linings and paint finishes to repair corroded cooling tower casings and fans.
- CleanSafe flooring and access doors/ systems for safer cleaning/ removal of packing and maintenance/ inspection of drift eliminators



# Vistech Markets

Wherever heat needs to be removed from a process or system, Vistech can help. Our knowledge and expertise, particularly within the industrial sector has allowed us to work with some of the most prestigious and recognised global brands.

- Chemicals
- Manufacturing
- Food & Beverage
- Automotive
- Defence
- Power
- Pharmaceuticals
- Metals

CRODA



**HONDA**



**DIAGEO**



**Balfour Beatty**

**GSK**



**INEOS**  
**Inovyn**

**CMB**  
**.TECH**



**Perkins**



**BAE SYSTEMS**

# Quality, Health & Safety and The Environment

Vistech operate an integrated management system in accordance with:

- UKAS - ISO 45001:2018
- UKAS - ISO 9001:2015
- UKAS - ISO 14001:2015

Vistech are members of the following SIPP schemes:

- CHAS
- Safecontractor
- Constructionline Gold



For more information visit:

<https://www.vistechcooling.co.uk/>

# Contact Us

## Vistech Cooling Systems Ltd

Unit 1A, Church Lane Estate

Church Lane, Plummers Plain

Horsham, UK

[info@vistechcooling.co.uk](mailto:info@vistechcooling.co.uk)

[vistechcooling.co.uk](http://vistechcooling.co.uk)

+44 (0)1403 892 622



DESIGN | INSTALL | MAINTAIN

*'To consistently design and install quality water cooling solutions'*